

2 Kennedy Square, Leamington Spa  
Offers Over £170,000

charlesrose.

GROUND FLOOR  
344 sq. ft. (32.0 sq. m.) approx.

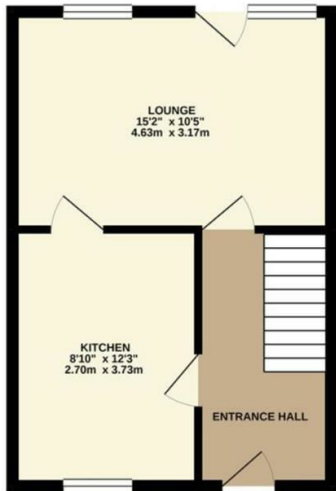

1ST FLOOR  
344 sq. ft. (32.0 sq. m.) approx.

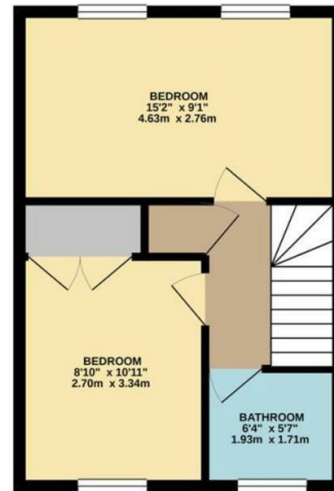

TOTAL FLOOR AREA : 688 sq. ft. (63.9 sq. m.) approx.  
Whilst every attempt has been made to ensure the accuracy of the floorplan contained here, measurements of doors, windows, rooms and any other items are approximate and no responsibility is taken for any error, omission or mis-statement. This plan is for illustrative purposes only and should be used as such by any prospective purchaser. The services, systems and appliances shown have not been tested and no guarantee as to their operability or efficiency can be given.  
Made with Metrage ©2020



A two bedroom duplex maisonette located in the heart of Leamington Spa. Located only 0.3 mile walk to the parade and 1 mile walk to the train station this is an ideal apartment for those looking for an investment or to live themselves in the vibrant town. The property briefly comprises an entrance hall, smart kitchen and lounge diner. Upstairs are two double bedrooms and a family bathroom. To the front of the maisonette is a small enclosed garden for table and chairs and a few steps away is a storage unit.

Opportunities to buy a town centre location at this price range are rare so book your own appointment with us today, to avoid disappointment.

Council Tax Band - A - £1,430 per year

charlesrose.

- 01926 832411
- [info@charlesroseproperties.co.uk](mailto:info@charlesroseproperties.co.uk)
- [www.charlesroseproperties.co.uk](http://www.charlesroseproperties.co.uk)

