

GROUND FLOOR
573 sq.ft. (53.2 sq.m.) approx.

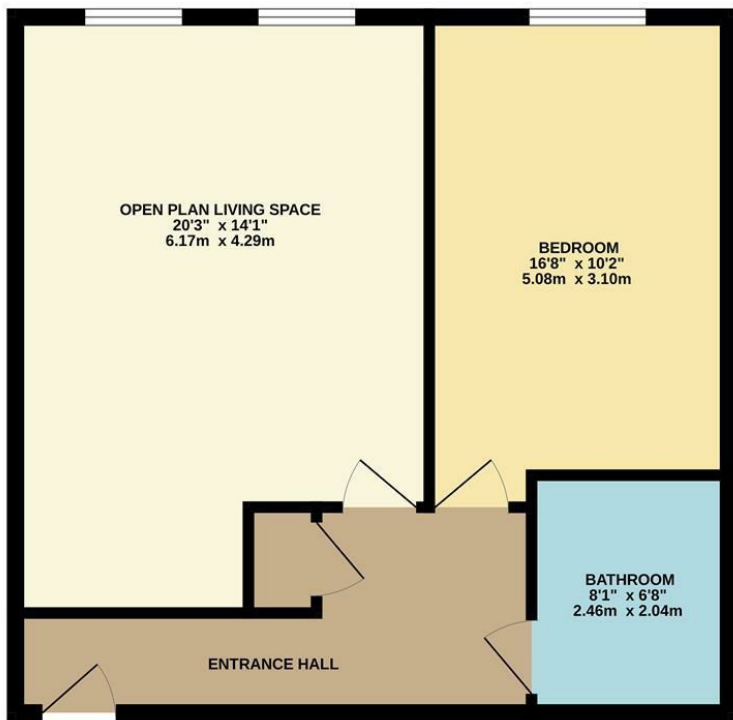

TOTAL FLOOR AREA : 573 sq.ft. (53.2 sq.m.) approx.
Whilst every attempt has been made to ensure the accuracy of the floorplan contained here, measurements of doors, windows, rooms and any other items are approximate and no responsibility is taken for any error, omission or mis-statement. This plan is for illustrative purposes only and should be used as such by any prospective purchaser. The services, systems and appliances shown have not been tested and no guarantee as to their operability or efficiency can be given.
Made with Metropix ©2023

Apartment 1, Lantern Mews 33-
£200,000

charlesrose.



Offered for sale with no onward chain, this superb first floor apartment is ideally situated on the tree lined Regent Grove, in the heart of Leamington Spa town centre. The accommodation comprises entrance hall, open plan kitchen living space, a good sized double bedroom and a bathroom. The property further benefits from gas central heating, an allocated parking space and is only a 0.6 mile walk to the train station. Having been rented out in previous years, we would expect a current rental income of £1,100 PCM, making it an ideal buy to let, or first time buy.

charlesrose.

- 01926 832411
- info@charlesroseproperties.co.uk
- www.charlesroseproperties.co.uk

