

42 Albert Street, Warwick
Offers Over £320,000

charlesrose.

GROUND FLOOR
405 sq.ft. (37.6 sq.m.) approx.

1ST FLOOR
306 sq.ft. (28.4 sq.m.) approx.

2ND FLOOR
246 sq.ft. (22.9 sq.m.) approx.

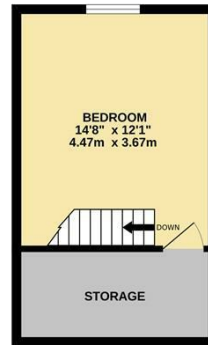
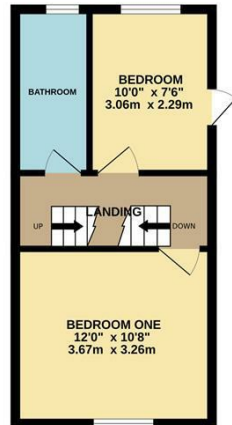

TOTAL FLOOR AREA: 957 sq.ft. (88.9 sq.m.) approx.
Whilst every attempt has been made to ensure the accuracy of the description contained here, measurements of doors, windows, rooms and any other items are approximate and no responsibility is taken for any error, omission or mis-statement. This plan is for illustrative purposes only and should be used as such by any prospective purchaser. The services, systems and appliances shown have not been tested and no guarantee as to their operability or efficiency can be given.
Made with Metropix ©2024



A fantastic example of a characterful, three bedroom terraced house on one of Warwick's most sought after roads. Located only 0.3 mile walk to Market Place and 0.5 mile walk to Warwick Train Station the property briefly comprises: two reception rooms, one of which leads into an open kitchen. On the first floor is a single bedroom, a double bedroom and family bathroom. On the second floor is a large double bedroom and further storage. Outside to the rear of the property is a pleasant garden.

Albert Street has won Warwick in Bloom for 4 consecutive years and gives a great sense of the type of community that exists there. Other similar houses locally have sold extremely quickly, so we advise you book your own viewing with us today to avoid disappointment.

Council Tax Band - C - £1,906 per year

charlesrose.

- 01926 832411
- info@charlesroseproperties.co.uk
- www.charlesroseproperties.co.uk

