

FIRST FLOOR
421 sq.ft. (39.1 sq.m.) approx.

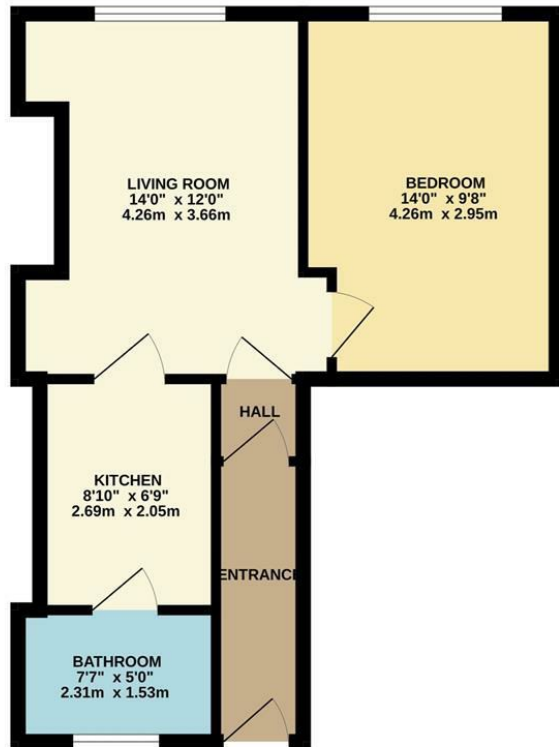

TOTAL FLOOR AREA : 421 sq.ft. (39.1 sq.m.) approx.

Whilst every attempt has been made to ensure the accuracy of the floorplan contained here, measurements of doors, windows, rooms and any other items are approximate and no responsibility is taken for any error, omission or mis-statement. This plan is for illustrative purposes only and should be used as such by any prospective purchaser. The services, systems and appliances shown have not been tested and no guarantee as to their operability or efficiency can be given.
Made with Metropix ©2023

47 Bedford Street, Leamington Spa
£975 Per Month

charlesrose.



Situated within a highly convenient central Leamington location, this newly converted first floor apartment.

Accommodation comprises private entrance hallway, spacious lounge, double bedroom, kitchen with brand new appliances and a shower room. The property also benefits from a communal roof terrace.

Professional Let Only

charlesrose.

- 01926 832411
- info@charlesroseproperties.co.uk
- www.charlesroseproperties.co.uk

