

21 Brackley Crescent, Warwick
£1,400 Per Month

charlesrose.

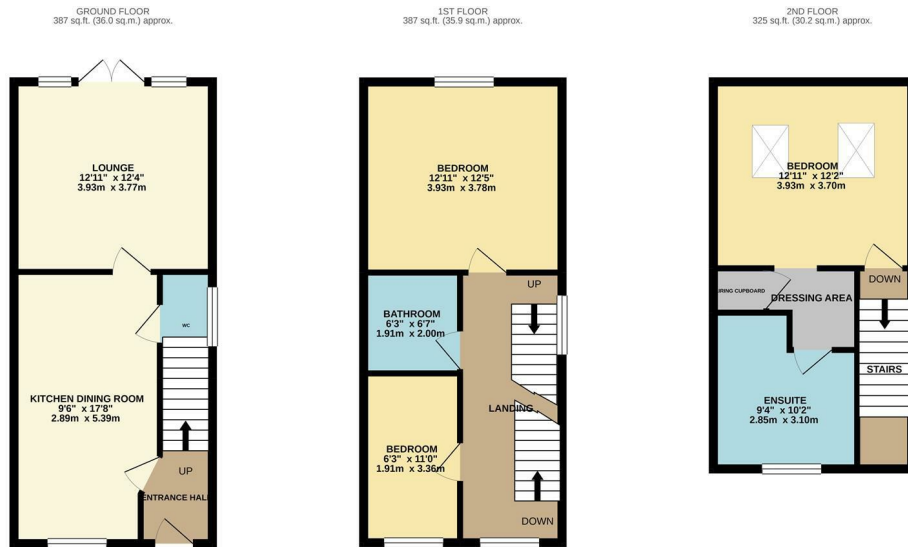

TOTAL FLOOR AREA: 1099 sq.ft. (102.1 sq.m.) approx.
Whilst every attempt has been made to ensure the accuracy of the floorplans contained here, measurements of doors, windows, rooms and any other items are approximate and no responsibility is taken for any error, omission or mis-statement. This plan is for illustrative purposes only and should be used as such by any prospective purchaser. The services, systems and appliances shown have not been tested and no guarantee as to their operability or efficiency can be given.
Made with Metreapp. ©2020.



A superbly presented three storey townhouse, located within a cul-de-sac on the sought after Chase Meadow development. On the ground floor the accommodation comprises entrance hall, kitchen dining room, W.C. and a lounge overlooking the garden. To the first floor there are two bedrooms and a family bathroom. The master bedroom and a large en-suite occupies the second floor. Outside the property further benefits from a driveway providing off-road parking for two vehicles and a attractive landscaped rear garden.

Because off the exceptional finish of this property and it's excellent location, interest in this property is expected to be high. Therefore arrange your own viewing by calling today, to avoid disappointment.

charlesrose.

- 01926 832411
- info@charlesroseproperties.co.uk
- www.charlesroseproperties.co.uk

